



F650 Euro Fill Kit Retrofit Instructions

Revision History		
P13FB-01F100-CA	Revision 1	03/03/2016

ROUSH CleanTech Liquid Propane Autogas Fuel Fill Retrofit: F650

OVERVIEW OF COMPONENTS

Bill of Materials

Part#	QTY	Description
P13FB-10D310-BA	1	BRKT FUEL FILL VLV
22-4945	1	Euro fill valve
14-6053-900	1	DUSTCAP W STRAP
11-341-0561	1	RIVET NYLON RIBBED SHANK
11-357-0324	4	M5 x 0.6mm, 20mm socket head screw
11-278-0311	4	Serrated Flange M5 Nut
11-278-0300	3	M8 J-CLIP
W500023-S437	3	M8 x1.25 x 20 BOLT
P13FB-01F100-CA	1	F650 Drop Frame Euro fill kit instructions
P07L3-9A095	1	350 PSIG pressure label
P07L3-9A095-A	1	Propane fuel only label
P11BB-01C200-B	1	Overflow protection device label

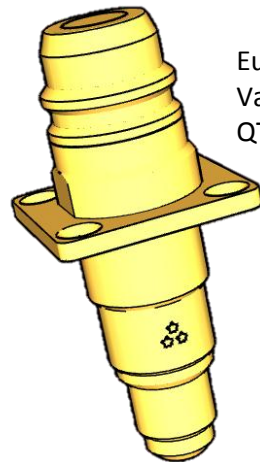
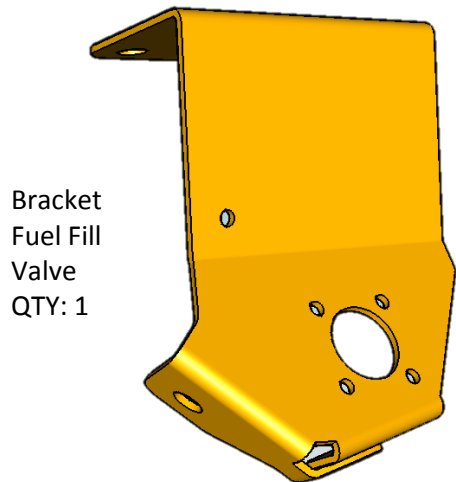

M8 x1.25 x 20 BOLT
QTY: 3

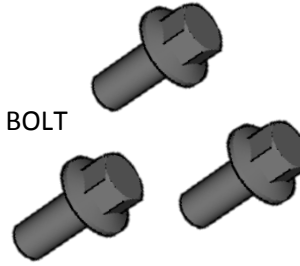

M5 X 0.6, 20mm
Socket Head Screw
QTY: 4

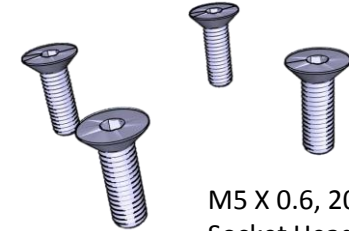

Serrated Flange
M5 Nut
QTY: 4

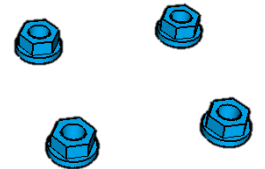

M8 J-CLIP
QTY: 3

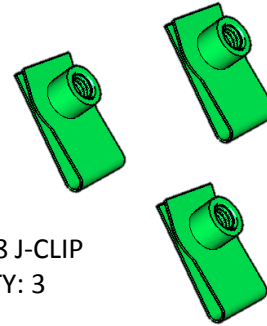

Rivet Nylon
Ribbed Shank
QTY: 1

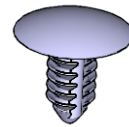

Dustcap W/Strap
QTY: 1

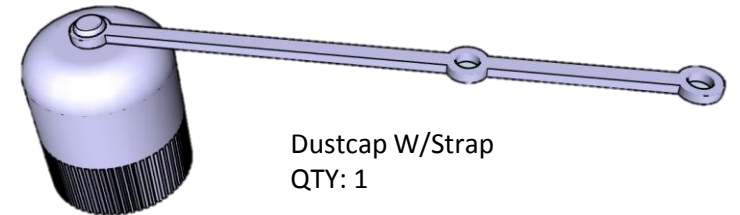

REMOVING ORIGINAL FUEL FILLER NECK



Note: Use caution when removing the filling line as there will be pressure trapped inside the line. Propane fuel is extremely cold when changing from a liquid to vapor state and will cause frostbite if it becomes in contact with skin. Ensure the proper eye protection and propane compatible gloves are used whenever fuel lines are being serviced. The propane in the filling line should depressurize within a couple minutes and the contents of the fuel tank will not be lost as the OPD in each fuel tank will remain checked. If the propane does not stop depressurizing after several minutes tighten the line back up and contact ROUSH CleanTech at 800-59-ROUSH (OPT 2) for technical assistance.

Step 1: Remove the fuel filler line from the fuel filler valve using a 7/8" Wrench.

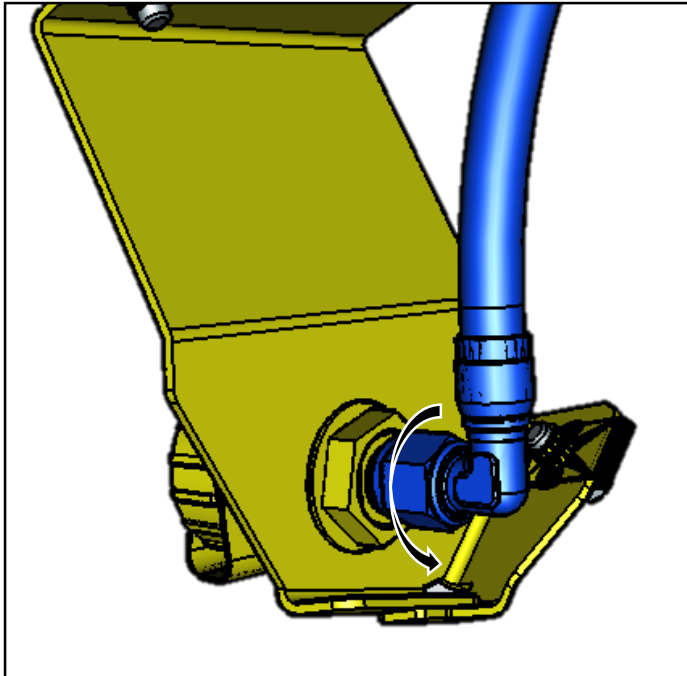

Step 2: Remove the fill valve locknut using a 1-1/4" wrench. Remove the Fill Valve.

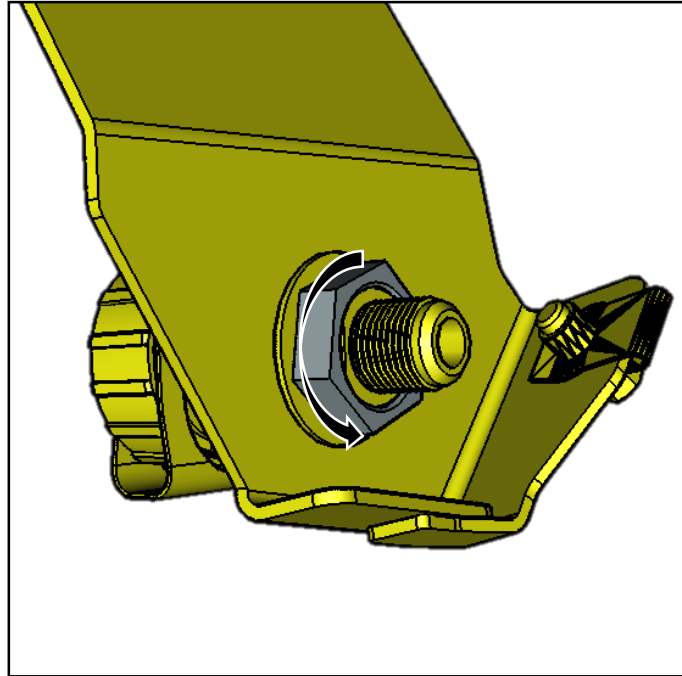

Step 3: Remove the three M8 mounting screws holding the bracket in place. Remove the bracket

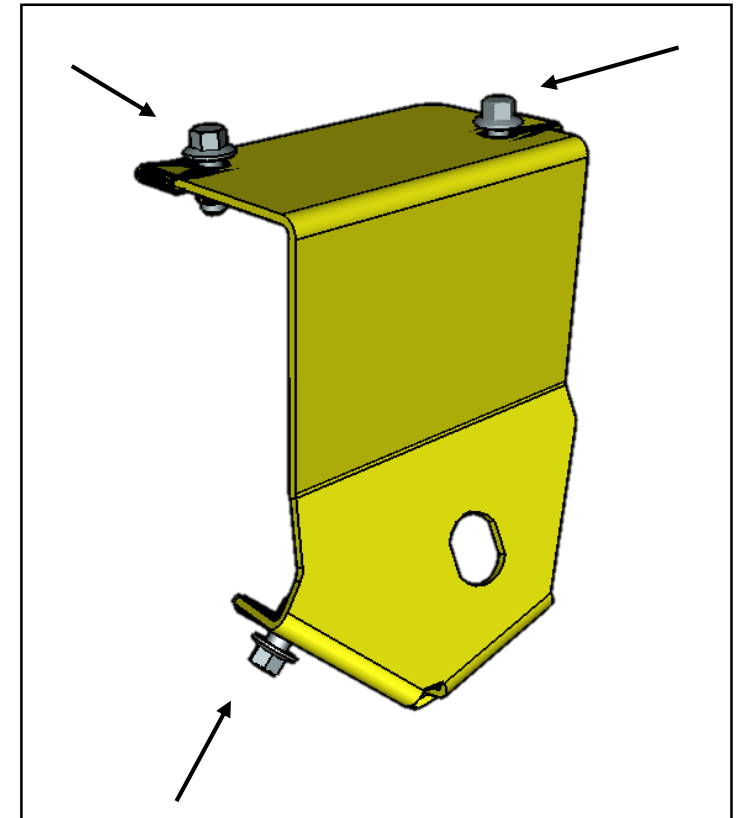

ASSEMBLE EURO FUEL FILLER NECK

Step 1: Install the euro fill valve into the bracket using four M5 socket head screws and four M5 serrated flange nuts
Tighten to 5-7Nm

Step 2: Install the filler cap tether by pushing the rivet through the furthest hole in the filler cap tether and through the specified hole in the bracket.

Step 3: Install the J-clips onto the bracket as shown

2b: Screw the filler cap onto the filler valve.

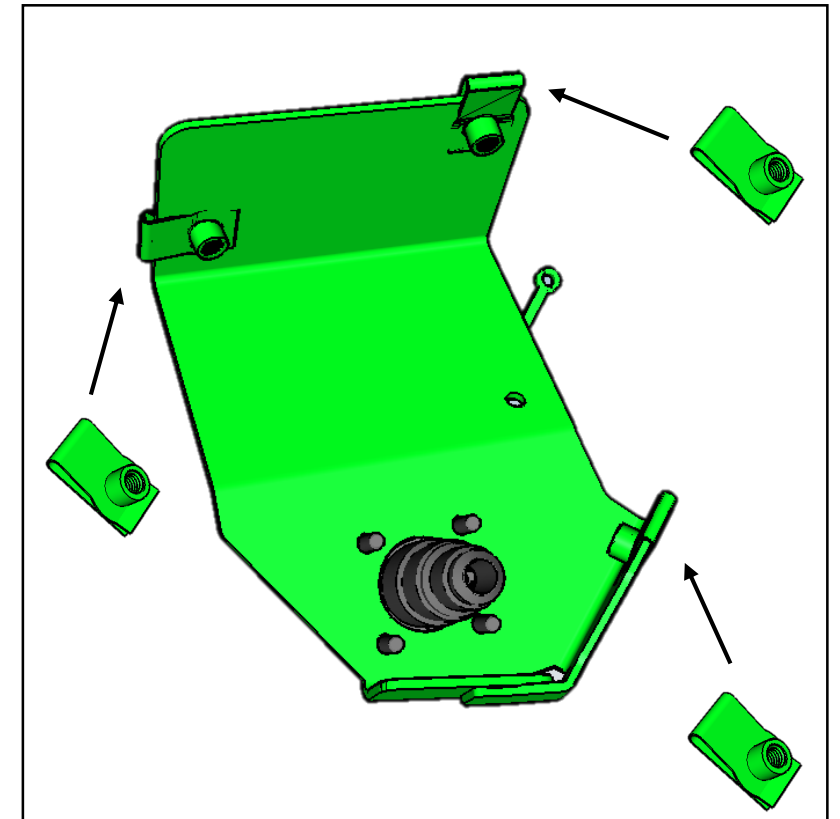
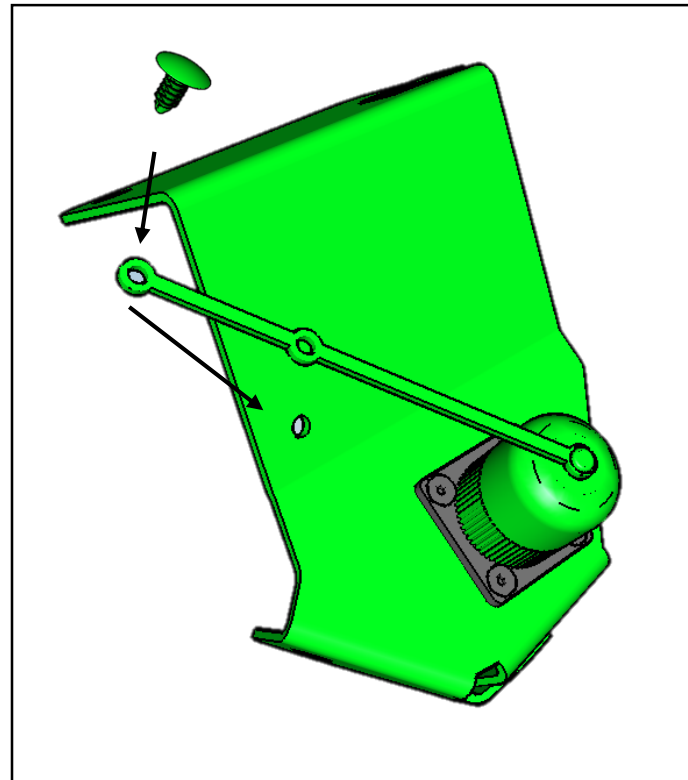
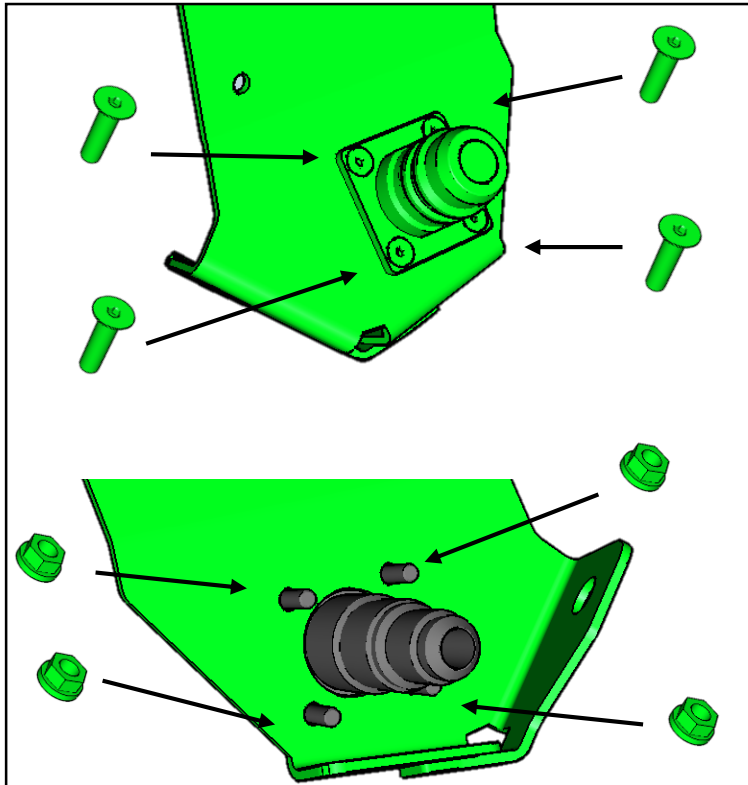

INSTALL EURO FUEL FILLER NECK

Step 1: Install the bracket into position using the three M8 bolts
Tighten to 20-30Nm

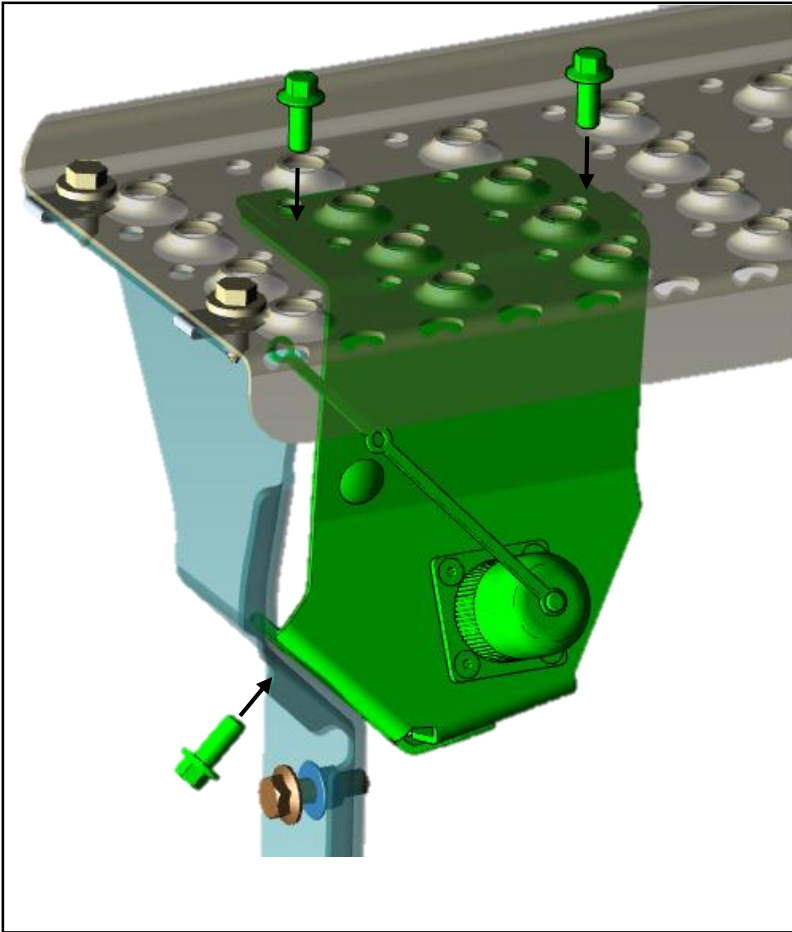

Step 2: Apply labels into position as shown

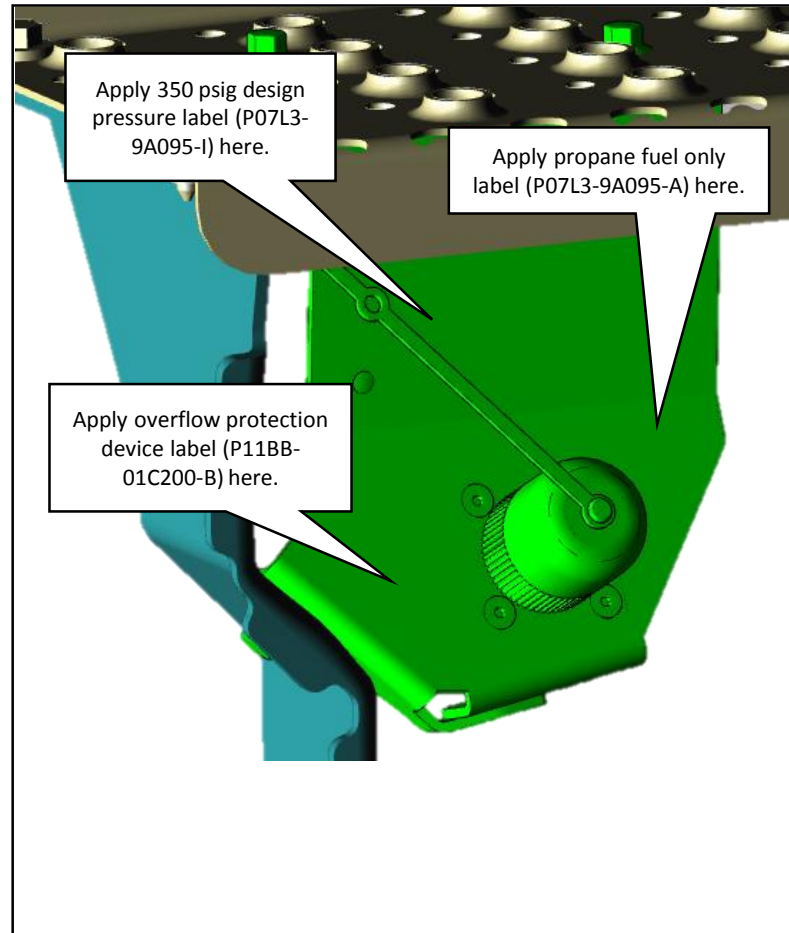

Step 3: Install the fuel fill line to the filler valve using a 7/8" Wrench. Tighten to 41-49 Nm.

